

Installation Dimension

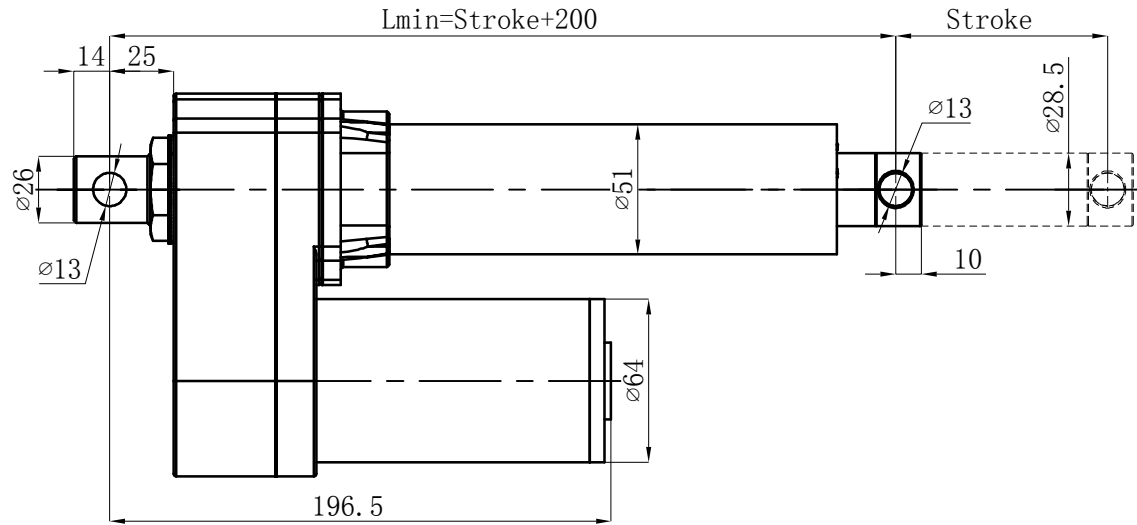
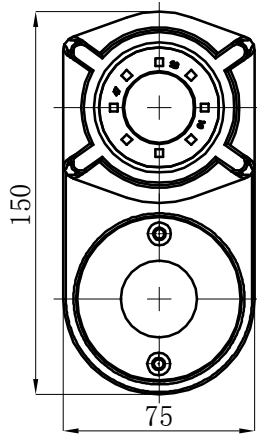

Specifications

1	Input Voltage	48V/36V/24V/12V DC
2	Load Capacity	10000N
3	Max Speed	5 mm/s (7000N)
		67 mm/s (750N)
4	Stroke	Customize
5	Type of duty	10%, 2 min. on/18 min. off
6	Limit switches	Inner
7	Operation Temperature	-15°C ~ 45°C
8	Color	Black or Gray
9	Protection Class	IP65

						Name	Installation Drawing	Figure Number	BM-H2
						Materials		Drawing	
Sign	Amount	Modify File Number	Signature	Date		Weight	Ratio	1:3	Lay Page
Designer			Standard						
Mapper									
Auditor									
Craft			Approver						
							Wuxi Borman Transmission Technology Co., LTD		