

Model: BM-10



Built in Potentiometer or Hall (Optional)

• Product Description

BM-10 linear actuator is our fundamental linear actuator making it an ideal choice for many projects. This electric actuator is an optimal choice when a high force, low current actuator is required. Some examples of the key industries that use this cost-effective actuator solution include the automotive, home automation, and medical industries. For improved control and accuracy of motion, the BM-10 can be customized depending on your application requirements.

• General Features

Input Voltage	24V/12V DC
Load Capacity	6000N
Speed	4~30mm/s
Stroke	Customize
Type of Duty	10%, 2min.on / 18min. off
Limit Switches	Inner
Operation Temperature	-15°C~45°C
Protection Class	IP43
Color	Black or Gray
Certificate	CE,ROHS,SAA,FCC

1

Installation Dimensions

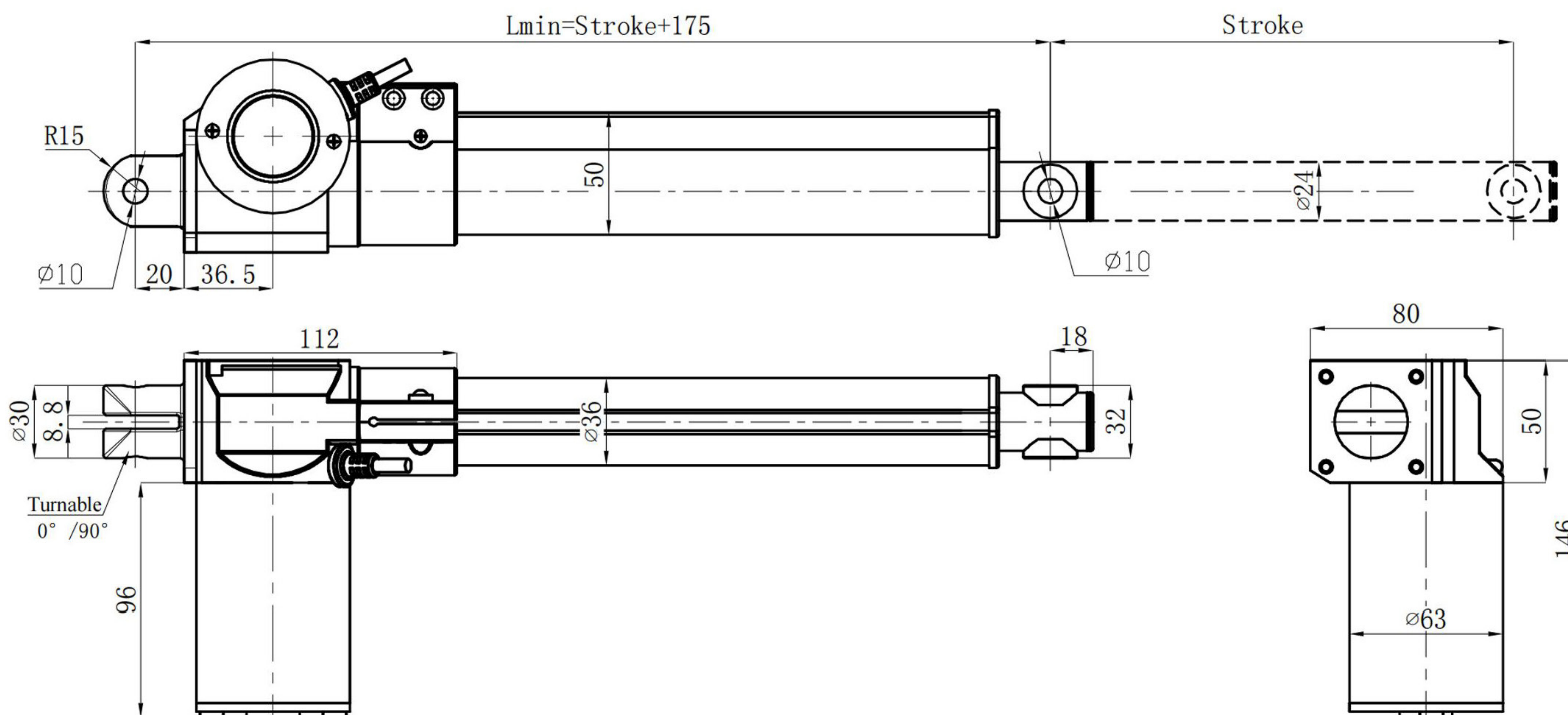

2

Load And Speed

CODE	Load (N)		Self Locking Force (N)	Typical Current (A)		Typical Speed (mm/s)	
	Push	Pull		No Load	With Load	No Load	With Load
				12V/24V/48V DC	12V/24V/48V DC	12V/24V/48V DC	12V/24V/48V DC

Motor Speed

Code	Load (N) Push	Load (N) Pull	Self Locking Force (N)	Typical Current (A) No Load	Typical Current (A) With Load	Typical Speed (mm/s) No Load	Typical Speed (mm/s) With Load
A	6000	6000	6000			4	3
B	5000	5000	5000			6	4
C	4000	4000	4000			8	6
D	2000	2000	2000			12	9
E	800	800	800			16	14
F	500	500	500			24	18

3