

Model:BM-H1

Product Description



BMH1 linear actuator is the proven choice for applications requiring a durable, long life solution. Specifically designed for harsh working environments, the BMH1 linear actuator is ideal for use in heavy-duty machinery, industrial equipment, commercial lawn mowers, scrubbers and sweepers, and material handling equipment. This linear actuator has been certified for applications requiring IP66 compliance.

A more powerful motor makes the BMH1 capable of handling load ratings up to 12000N(2645lbs). For improved control and accuracy of motion, the BMH1 can be customized with many different feedback options depending on your application requirements. Options include feedback sensors, signal sending limit switches and 90 degree clevis mounting.

General Features

Input Voltage	72V/48V/36V/24V/12V DC
Load Capacity	2697.71lbs
Speed	0.20-2.36inch/s
Stroke	Customize
Type of Duty	10%, 2min.on / 18min. off
Limit Switches	Inner
Operation Temperature	-15°C~45°C
Protection Class	IP65
Color	Black or Gray
Certificate	CE,UL

1

Installation Dimensions

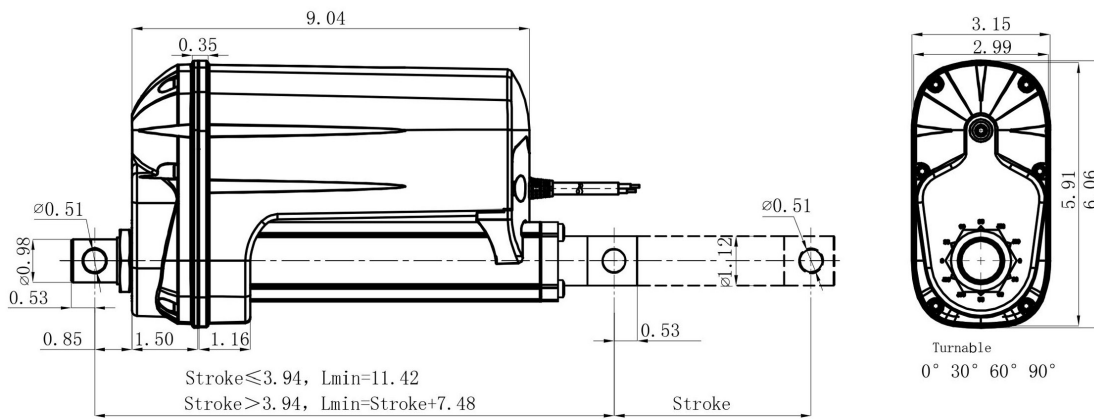

2

Load And Speed

CODE	Load (lbs)		Self Locking Force (lbs)	Typical Current (A)		Typical Speed (inch/s)	
	Push	Pull		No Load 12V/24V DC	With Load 12V/24V DC	No Load 12V/24V/48V DC	With Load 12V/24V/48V DC

Motor Speed							
A	2645	2645	3307	4/2.4	20/10.5	0.26	0.12
B	2425	2425	2645	4/2.4	20/10.5	0.33	0.24
C	2205	2205	2645	4/2.4	20/10.5	0.51	0.28
D	1653	1653	1984	4/2.4	20/10.5	0.51	0.35
E	1543	1543	1763	4/2.4	20/10.5	0.67	0.37
F	1433	1433	1763	4/2.4	20/10.5	0.79	0.43
G	1102	1102	1323	4/2.4	20/10.5	0.98	0.55
H	992	992	1213	4/2.4	20/10.5	0.98	0.51
I	882	882	1102	4/2.4	20/10.5	1.18	0.59
J	705	705	882	4/2.4	20/10.5	1.50	0.94
K	661	661	882	4/2.4	20/10.5	1.57	0.79
L	441	441	661	4/2.4	20/10.5	2.36	1.18

3