

Model:BM-H1

Product Description



BMH1 linear actuator is the proven choice for applications requiring a durable, long life solution. Specifically designed for harsh working environments, the BMH1 linear actuator is ideal for use in heavy-duty machinery, industrial equipment, commercial lawn mowers, scrubbers and sweepers, and material handling equipment. This linear actuator has been certified for applications requiring IP66 compliance.

A more powerful motor makes the BMH1 capable of handling load ratings up to 12000N(2645lbs). For improved control and accuracy of motion, the BMH1 can be customized with many different feedback options depending on your application requirements. Options include feedback sensors, signal sending limit switches and 90 degree clevis mounting.

General Features

Input Voltage	72V/48V/36V/24V/12V DC
Load Capacity	12000N
Speed	5-60mm/s
Stroke	Customize
Type of Duty	10%, 2min.on / 18min. off
Limit Switches	Inner
Operation Temperature	-20°C-65°C
Protection Class	IP66
Color	Black or Gray
Certificate	CE,UL

1

Installation Dimensions

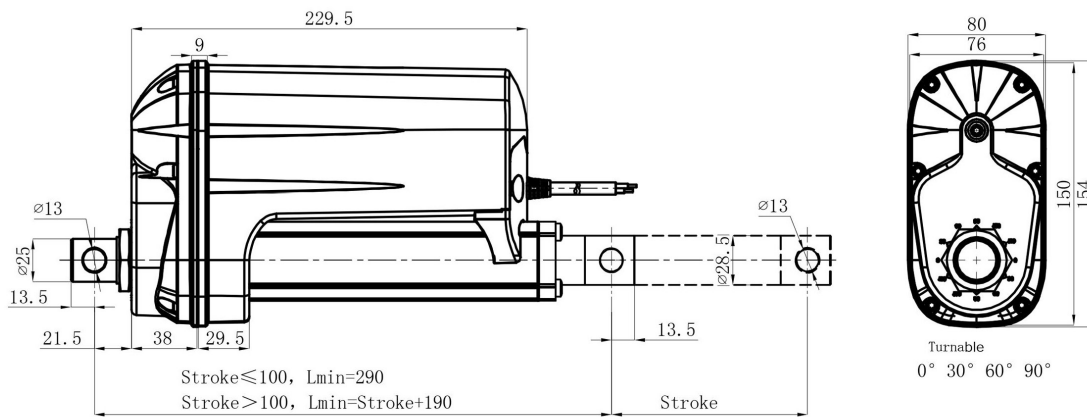

2

Load And Speed

CODE	Load (N)		Self Locking Force (N)	Typical Current (A)		Typical Speed (mm/s)	
	Push	Pull		No Load 12V/24V DC	With Load 12V/24V DC	No Load 12V/24V/48V DC	With Load 12V/24V/48V DC

Motor Speed							
A	12000	12000	15000	4/2.4	20/10.5	7	6
B	11000	11000	12000	4/2.4	20/10.5	9	8
C	10000	10000	12000	4/2.4	20/10.5	11	9
D	7500	7500	9000	4/2.4	20/10.5	14	12
E	7000	7000	8000	4/2.4	20/10.5	19	16
F	6500	6500	8000	4/2.4	20/10.5	17	16
G	5000	5000	6000	4/2.4	20/10.5	27	25
H	4500	4500	5500	4/2.4	20/10.5	35	31
I	4000	4000	5000	4/2.4	20/10.5	56	54
J	3200	3200	4000	4/2.4	20/10.5	56	54
K	3000	3000	4000	4/2.4	20/10.5	56	54
L	2000	2000	3000	4/2.4	20/10.5	56	54

3