

Model: BM-H2



Built in Potentiometer or Hall (Optional)

Product Description

BMH2 was specifically designed for heavy-duty applications and harsh working environments that require durability. For improved control and accuracy of motion, the BMH2 can be customized with many different feedback options depending on your application requirements.

Examples of applications suitable for the BMH2: Agricultural equipment such as spreaders, harvesters, grain handlers, combines and tractors. Commercial and industrial applications such as window automation, commercial lawn mowers, scrubbers and sweepers and material handling equipment. These were some major industrial application area, which use the electric linear actuators extensively. Employing these actuators in these applications increases the overall efficiency, and betters the performance.

General Features

Input Voltage	48V/36V/36V/24V/12V DC
Load Capacity	10000N
Speed	5-67mm/s
Stroke	Customize
Type of Duty	10%, 2min.on / 18min. off
Limit Switches	Inner
Operation Temperature	-15°C~45°C
Protection Class	IP65
Color	Black or Gray
Certificate	CE

1

Installation Dimensions

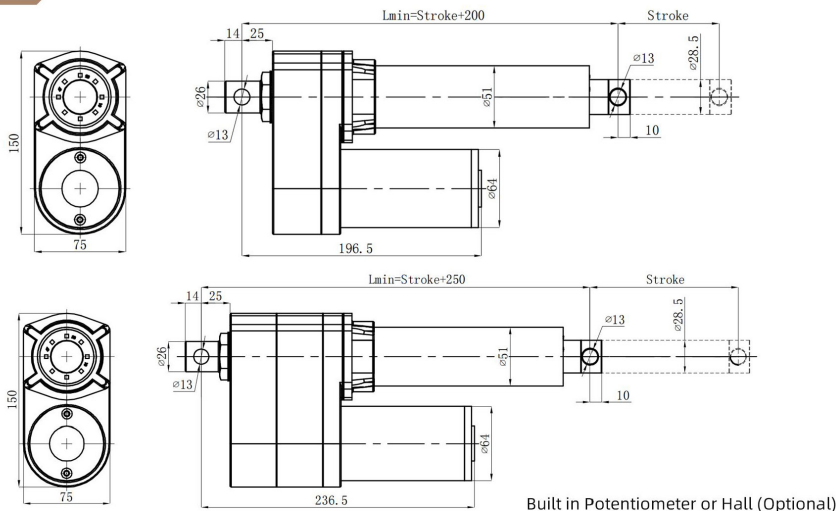

2

Load And Speed

CODE	Load (N)		Self Locking Force (N)	Typical Current (A)		Typical Speed (mm/s)	
	Push	Pull		No Load 12V/24V/48V DC	With Load 12V/24V/48V DC	No Load 12V/24V/48V DC	With Load 12V/24V/48V DC

Motor Speed							
A	10000	10000	11000	1.3/0.9/0.5	22/14/6	6.5	3.5
B	9000	9000	10000	1.3/0.9/0.5	22/14/6	8.5	5
C	7000	7000	8000	1.3/0.9/0.5	22/12/6	12.5	9
D	4000	4000	5000	1.5/1/0.6	18/12/5	20	13
E	3000	3000	4000	1.8/1.3/0.6	20/13/5	22	14
F	2000	2000	3000	3.0/2.5/0.7	18/13/3.5	53	30
G	1500	1500	2500	3.5/2.5/0.6	20/12/5	100	65
H	1000	1000	2000	3.5/2.5/1.0	20/13/6	160	80

3